



PRESENTA

**BANKO**  
INDUSTRIAL POWER TOOLS



PATENTED TECHNOLOGY

Le Macchine Pneumatiche  
per chi vuole potenza!





**STUCCHI** è presente dal 1979 sul mercato mondiale come produttore leader di impianti ad albero flessibile. I nostri prodotti, legati alla produzione industriale ed anche all'hobbistica, risultano essere molto utili per operazioni di: pulitura, satinatura, sgrossatura, lucidatura dei metalli e molto altro.



**DIE M-0**

Die grinder with collet (CE)

**DIE EXTENDED M-0**

Die grinder with collet (CE)

Order number	GDB01 D18 CE	GDB01 D25 CE	GDB01 E18 CE	GDB01 E25 CE
Model	Banko M0 DIE	Banko M0 DIE	Banko M0 DIE EXTENDED	Banko M0 DIE EXTENDED
Max. free speed (rpm)	18000	25000	18000	25000
Collet (mm)	6	6	6	6
Rec. / max. dia. carbide burr (mm)	12/16	12/16	12/16	12/16
Rec. / max. dia. mounted point (mm)	20/25	20/25	20/25	20/25
Maximum Power (kW)	0.75	0.75	0.75	0.75
Weight (kg)	0.8	0.8	1.0	1.0
Lenght (mm)	215	215	322	322
Rec. hose dia. (mm)	10	10	10	10
Air inlet thread	3/8"	3/8"	3/8"	3/8"
Optimal pressure (bar)	6,3	6,3	6,3	6,3
Air consumption max/free (l/sec)	14/8	14/8	14/8	14/8
Exhaust	Rear	Rear	Rear	Rear
Noise (dB)	85	84	85	84
Vibration	<2,5 m/s <sup>2</sup>	<2,5 m/s <sup>2</sup>	<2,5 m/s <sup>2</sup>	<2,5 m/s <sup>2</sup>

Collet: standard delivery 6 mm. Optional dimension of collet available (please specify when ordering)



Recommendation for GDB01 DIE and DIE EXTENDED models (article C1-16-01):  
1 m supply air hose with coupling and silencer



**DIE M-1**  
Die grinder with collet (CE)

**DIE M-1 VD**  
Die grinder with collet (CE)

Order number	GDB11 D25 CE	GDB11 D18 CE	GDB11 D25 CE VD	GDB11 D18 CE VD
Model	Banko M1 DIE	Banko M1 DIE	Banko M1 DIE VD	Banko M1 DIE VD
Max. free speed (rpm)	25000	18000	25000	18000
Collet (mm)	6/8	6/8	6/8	6/8
Rec. / max. dia. carbide burr (mm)	12/16	16/16	12/16	16/16
Rec. / max. dia. mounted point (mm)	25/32	32/40	25/32	32/40
Maximum Power (kW)	1.4	1.3	1.4	1.3
Weight (kg)	1.1	1.1	1.1	1.1
Length (mm)	234	234	234	234
Rec. hose dia. (mm)	13	13	13	13
Air inlet thread	1/2"	1/2"	1/2"	1/2"
Optimal pressure (bar)	6,3	6,3	6,3	6,3
Air consumption max/free (l/sec)	20/12	18/12	20/12	18/12
Exhaust	Rear	Rear	Rear	Rear
Noise (dB)	90	87	90	87
Vibration	<2,5 m/s <sup>2</sup>	<2,5 m/s <sup>2</sup>	<2,5 m/s <sup>2</sup>	<2,5 m/s <sup>2</sup>

Collet: standard delivery 6 mm. Optional dimension of collet available (please specify when ordering)

**VD - VIBRATION DUMPED MACHINE**  
for smooth grinding without chatters (only carbide burrs)



Recommendation for GDB11 DIE and DIE EXTENDED models (article B1-16-03):  
1 m supply air hose with coupling and silencer



**DIE EXTENDED M-1**

Die grinder with collet (CE)

**DIE EXTENDED M-3**

Die grinder with collet (CE)

Order number	GDB11 E25 CE	GDB11 E18 CE	GDB31 E18 CE
Model	Banko M1 DIE EXTENDED	Banko M1 DIE EXTENDED	Banko M3 DIE EXTENDED
Max. free speed (rpm)	25000	18000	18000
Collet (mm)	6/8	6/8	6/8
Rec. / max. dia. carbide burr (mm)	12/16	16/16	16/16
Rec. / max. dia. mounted point (mm)	20/32	32/40	32/40
Maximum Power (kW)	1.4	1.3	2.0
Weight (kg)	1.5	1.5	1.9
Length (mm)	372	372	394
Rec. hose dia. (mm)	13	13	13
Air inlet thread	1/2"	1/2"	1/2"
Optimal pressure (bar)	6,3	6,3	6,3
Air consumption max/free (l/sec)	20/12	18/12	30/16
Exhaust	Rear	Rear	Rear
Noise (dB)	90	87	91
Vibration	<2,5 m/s <sup>2</sup>	<2,5 m/s <sup>2</sup>	<3,7 m/s <sup>2</sup>

Collet: standard delivery 6 mm. Optional dimension of collet available (please specify when ordering)



Recommendation for GDB11 DIE and DIE EXTENDED models (article B1-16-03):  
1 m supply air hose with coupling and silencer

Recommendation for GDB31 DIE and DIE EXTENDED models (article B3-16-01):  
1 m supply air hose with coupling and silencer



### DIE EXTENDED M-1

Die grinder with collet (CE) EXTENDED VERSION

Order number	GDB11 2EE 25 CE	GDB11 3EE 25 CE	GDB11 4EE 25 CE	GDB11 5EE 25 CE
Model	Banko M1 DIE EXTENDED	Banko M1 DIE EXTENDED	Banko M1 DIE EXTENDED	Banko M1 DIE EXTENDED
Max. free speed (rpm)	25.000	25.000	25.000	25.000
Collet (mm)	6/8	6/8	6/8	6/8
Rec. / max. dia. carbide burr (mm)	12/16	12/16	12/16	12/16
Rec. / max. dia. mounted point (mm)	20/32	20/32	20/32	20/32
Maximum Power (kW)	1.4	1.4	1.4	1.4
Weight (kg)	2.3	2.7	3.1	3.6
Length (mm)	655	795	935	1075
Rec. hose dia. (mm)	13	13	13	13
Air inlet thread	1/2"	1/2"	1/2"	1/2"
Optimal pressure (bar)	6,3	6,3	6,3	6,3
Air consumption max/free (l/sec)	20/12	20/12	20/12	20/12
Exhaust	Rear	Rear	Rear	Rear
Noise (dB)	90	90	90	90
Vibration	<2,5 m/s <sup>2</sup>	<2,5 m/s <sup>2</sup>	<2,5 m/s <sup>2</sup>	<2,5 m/s <sup>2</sup>

Collet: standard delivery 6 mm. Optional dimension of collet available (please specify when ordering)

#### Extension - info:

140 mm length per extension part  
with spindle thread  
3 ball bearings  
Connector for spindle  
Outside diameter: 28 mm

#### Available on request:

Other lengths



Recommendation for GDB11 DIE and DIE EXTENDED models (article B1-16-03):  
1 m supply air hose with coupling and silencer



### DIE EXTENDED M-3

Die grinder with collet (CE) EXTENDED VERSION

Order number	GDB31 2EE 18 CE	GDB31 3EE 18 CE	GDB31 4EE 18 CE	GDB31 5EE 18 CE
Model	Banko M3 DIE EXTENDED	Banko M3 DIE EXTENDED	Banko M3 DIE EXTENDED	Banko M3 DIE EXTENDED
Max. free speed (rpm)	18000	18000	18000	18000
Collet (mm)	6/8	6/8	6/8	6/8
Rec. / max. dia. carbide burr (mm)	16/16	16/16	16/16	16/16
Rec. / max. dia. mounted point (mm)	32/40	32/40	32/40	32/40
Maximum Power (kW)	2.0	2.0	2.0	2.0
Weight (kg)	2.6	3.0	3.5	3.9
Length (mm)	667	807	947	1087
Rec. hose dia. (mm)	13	13	13	13
Air inlet thread	1/2"	1/2"	1/2"	1/2"
Optimal pressure (bar)	6,3	6,3	6,3	6,3
Air consumption max/free (l/sec)	30/16	30/16	30/16	30/16
Exhaust	Rear	Rear	Rear	Rear
Noise (dB)	91	91	91	91
Vibration	<3,7 m/s <sup>2</sup>	<3,7 m/s <sup>2</sup>	<3,7 m/s <sup>2</sup>	<3,7 m/s <sup>2</sup>

Collet: standard delivery 6 mm. Optional dimension of collet available (please specify when ordering)

#### Extension - info:

140 mm length per extension part  
with spindle thread  
3 ball bearings  
Connector for spindle  
Outside diameter: 28 mm

#### Available on request:

Other lengths



Recommendation for GDB31 DIE and DIE EXTENDED models (article B3-16-01):

1 m supply air hose with coupling and silencer



VANE MACHINE OIL FREE

Oiled air can be used at any time, increases the service life of the machine

Patented technology



**DIE EXTENDED M-1**

Die grinder for grinding tools with thread (CW)

**DIE EXTENDED M-3**

Die grinder for grinding tools with thread (CW)

Order number	GDB11 E25 CW	GDB11 E18 CW	GDB31 E18 CW
Model	Banko M1 DIE EXTENDED	Banko M1 DIE EXTENDED	Banko M3 DIE EXTENDED
Max. free speed (rpm)	25000	18000	18000
Spindle thread	M12x1*	M12x1*	M12x1*
Rec. / max. dia. cone wheel (50 m/s)	32/40	40/50	50/50
Maximum Power (kW)	1.4	1.3	2.0
Weight (kg)	1.5	1.5	1.9
Lenght (mm)	346	346	372
Rec. hose dia. (mm)	13	13	13
Air inlet thread	1/2"	1/2"	1/2"
Optimal pressure (bar)	6,3	6,3	6,3
Air consumption max/free (l/sec)	20/12	18/12	30/16
Exhaust	Rear	Rear	Rear
Noise (dB)	90	87	91
Vibration	<2,5 m/s <sup>2</sup>	<2,5 m/s <sup>2</sup>	<3,7 m/s <sup>2</sup>

\* INFO: 1 machine = 1 adapter free of charge (adapter size - page with adapter - please specify when ordering)



Recommendation for GDB11 DIE and DIE EXTENDED models (article B1-16-03):  
1 m supply air hose with coupling and silencer

Recommendation for GDB31 DIE and DIE EXTENDED models (article B3-16-01):  
1 m supply air hose with coupling and silencer



### DIE EXTENDED M-1

Die grinder for grinding tools with thread (CW) EXTENDED VERSION

Order number	GDB11 2EE 25 CW	GDB11 3EE 25 CW	GDB11 4EE 25 CW	GDB11 5EE 25 CW
Model	Banko M1 DIE EXTENDED	Banko M1 DIE EXTENDED	Banko M1 DIE EXTENDED	Banko M1 DIE EXTENDED
Max. free speed (rpm)	25.000	25.000	25.000	25.000
Spindle thread	M12x1*	M12x1*	M12x1*	M12x1*
Rec. / max. dia. cone wheel (50 m/s)	32/40	32/40	32/40	32/40
Maximum Power (kW)	1.4	1.4	1.4	1.4
Weight (kg)	2.6	3.0	3.5	3.9
Length (mm)	640	795	935	1075
Rec. hose dia. (mm)	13	13	13	13
Air inlet thread	1/2"	1/2"	1/2"	1/2"
Optimal pressure (bar)	6,3	6,3	6,3	6,3
Air consumption max/free (l/sec)	20/12	20/12	20/12	20/12
Exhaust	Rear	Rear	Rear	Rear
Noise (dB)	90	90	90	90
Vibration	<2,5 m/s <sup>2</sup>	<2,5 m/s <sup>2</sup>	<2,5 m/s <sup>2</sup>	<2,5 m/s <sup>2</sup>

\* INFO: 1 machine = 1 adapter free of charge (adapter size - page with adapter - please specify when ordering)

#### Extension - info:

140 mm length per extension part  
with spindle thread  
3 ball bearings  
Connector for spindle  
Outside diameter: 28 mm

#### Available on request:

Other lengths



Recommendation for GDB11 DIE and DIE EXTENDED models (article B1-16-03):  
1 m supply air hose with coupling and silencer



### DIE EXTENDED M-3

Die grinder for grinding tools with thread (CW) EXTENDED VERSION

Order number	GDB31 2EE 18 CW	GDB31 3EE 18 CW	GDB31 4EE 18 CW	GDB31 5EE 18 CW
Model	Banko M3 DIE EXTENDED	Banko M3 DIE EXTENDED	Banko M3 DIE EXTENDED	Banko M3 DIE EXTENDED
Max. free speed (rpm)	18000	18000	18000	18000
Spindle thread	M12x1*	M12x1*	M12x1*	M12x1*
Rec. / max. dia. cone wheel (50 m/s)	40/50	40/50	40/50	40/50
Maximum Power (kW)	2.0	2.0	2.0	2.0
Weight (kg)	2.6	3.0	3.5	3.9
Length (mm)	667	807	947	1087
Rec. hose dia. (mm)	13	13	13	13
Air inlet thread	1/2"	1/2"	1/2"	1/2"
Optimal pressure (bar)	6,3	6,3	6,3	6,3
Air consumption max/free (l/sec)	30/16	30/16	30/16	30/16
Exhaust	Rear	Rear	Rear	Rear
Noise (dB)	91	91	91	91
Vibration	<3,7 m/s <sup>2</sup>	<3,7 m/s <sup>2</sup>	<3,7 m/s <sup>2</sup>	<3,7 m/s <sup>2</sup>

\* INFO: 1 machine = 1 adapter free of charge (adapter size - page with adapter - please specify when ordering)

#### Extension - info:

140 mm length per extension part  
with spindle thread  
3 ball bearings  
Connector for spindle  
Outside diameter: 28 mm

#### Available on request:

Other lengths



Recommendation for GDB31 DIE and DIE EXTENDED models (article B3-16-01):

1 m supply air hose with coupling and silencer



**STRAIGHT M-3**

Straight grinder for grinding tools with thread (CW)

**STRAIGHT M-4**

Straight grinder for grinding tools with thread (CW)

Order number	GSB31 S18 CW	GSB31 S15 CW	GSB41 S12 CW	GSB41 S10 CW
Model	Banko M3 STRAIGHT	Banko M3 STRAIGHT	Banko M4 STRAIGHT	Banko M4 STRAIGHT
Max. free speed (rpm)	18000	15000	12000	10000
Spindle thread	M12x1*	M12x1*	M12x1*	M12x1*
Rec. / max. dia. cone wheel (50 m/s)	40/50	50/63	63/80	80/100
Maximum Power (kW)	2.0	1.9	3.1	3.0
Weight (kg)	2.2	2.2	2.9	2.9
Length (mm)	440	440	435	435
Rec. hose dia. (mm)	13	13	19	19
Air inlet thread	1/2"	1/2"	1/2"	1/2"
Optimal pressure (bar)	6,3	6,3	6,3	6,3
Air consumption max/free (l/sec)	32/16	30/16	47/18	47/16
Exhaust	Lateral	Lateral	Lateral	Lateral
Noise (dB)	91	89	89	87
Vibration	<3,5 m/s <sup>2</sup>	<3,3 m/s <sup>2</sup>	<4,5 m/s <sup>2</sup>	<4,3 m/s <sup>2</sup>

\* INFO: 1 machine = 1 adapter free of charge (adapter size - page with adapter - please specify when ordering)

Available on request: Version with collet

**STRAIGHT M-4 POWER**

Straight grinder for grinding tools with thread (CW)

Order number	GSB41P S10 CW	GSB41P S85 CW	GSB41P S66 CW
Model	Banko M4P Straight	Banko M4P Straight	Banko M4P Straight
Max. free speed (rpm)	10000	8500	6600
Spindle thread	M12 x 1	M12 x 1	M12 x 1
Rec/max dia. cone wheel (50 m/s)	80/100	80/100	80/100
Maximum Power (kW)	3.3	3.3	3.2
Weight (kg)	4.2	4.2	4.2
Length (mm)	470	470	470
Rec. hose dia. (mm)	16	16	16
Air inlet thread	1/2"	1/2"	1/2"
Optimal pressure (bar)	6,3	6,3	6,3
Air consumption max/free (l/sec)	52/18	51/18	51/18
Exhaust	Lateral	Lateral	Lateral
Noise (dB)	93	91	89
Vibration	<4,6 m/s <sup>2</sup>	<4,3 m/s <sup>2</sup>	<4,1 m/s <sup>2</sup>

\* INFO: 1 machine = 1 adapter free of charge (adapter size - page with adapter - please specify when ordering)

## VANE MACHINE OIL FREE

Oiled air can be used at any time, increases the service life of the machine

Patented technology



### STRAIGHT M-3

Straight grinder for straight wheel (SW)

Order number	GSB31 S18 SW	GSB31 S15 SW
Model	Banko M3 STRAIGHT	Banko M3 STRAIGHT
Max. free speed (rpm)	18000	15000
Spindle thread	UNC 5/8x55*	UNC 5/8x55*
Rec. / max. dia. straight wheel (80 m/s)	80/80	80/80
Maximum Power (kW)	2.0	1.9
Weight (kg)	2.2	2.2
Lenght (mm)	472	472
Rec. hose dia. (mm)	13	13
Air inlet thread	1/2"	1/2"
Optimal pressure (bar)	6,3	6,3
Air consumption max/free (l/sec)	32/16	30/16
Exhaust	Lateral	Lateral
Noise (dB)	91	89
Vibration	<3,5 m/s <sup>2</sup>	<3,3 m/s <sup>2</sup>

\* INFO: 1 machine = 1 adapter free of charge

(adapter size - page with adapter - please specify when ordering)

### STRAIGHT M-4

Straight grinder for straight wheel (SW)

### STRAIGHT M-4 POWER

Straight grinder for straight wheel (SW)

Order number	GSB41 S12 SW	GSB41 S10 SW	GSB41P S10 SW	GSB41P S85 SW	GSB41P S66 SW
Model	Banko M4 STRAIGHT	Banko M4 STRAIGHT	Banko M4P Straight	Banko M4P Straight	Banko M4P Straight
Max. free speed (rpm)	12000	10000	10000	8500	6600
Spindle thread	UNC 5/8x55*	UNC 5/8x55*	UNC 5/8x55 *	UNC 5/8x55 *	UNC 5/8x55 *
Rec. / max. dia. straight wheel (80 m/s)	125/125	125/150	125/150	180/180	230/230
Maximum Power (kW)	3.1	3.0	3.3	3.3	3.2
Weight (kg)	2.9	2.9	4.2	4.2	4.2
Lenght (mm)	467	467	470	470	470
Rec. hose dia. (mm)	19	19	16	16	16
Air inlet thread	1/2"	1/2"	1/2"	1/2"	1/2"
Optimal pressure (bar)	6,3	6,3	6,3	6,3	6,3
Air consumption max/free (l/sec)	50/18	48/18	52/18	51/18	51/18
Exhaust	Lateral	Lateral	Lateral	Lateral	Lateral
Noise (dB)	89	87	93	91	89
Vibration	<4,5 m/s <sup>2</sup>	<4,3 m/s <sup>2</sup>	<4,6 m/s <sup>2</sup>	<4,3 m/s <sup>2</sup>	<4,1 m/s <sup>2</sup>

\* INFO: 1 machine = 1 adapter free of charge (adapter size - page with adapter - please specify when ordering)



**STRAIGHT M-3**

Straight grinder with collet (CE)

Order number	GSB31 S18 CE
Model	Banko M3 STRAIGHT
Max. free speed (rpm)	18000
Collet diameter (mm)	6/8
Maximum Power (kW)	2.0
Weight (kg)	2.2
Length (mm)	440
Rec. hose dia. (mm)	13
Air inlet thread	1/2"
Optimal pressure (bar)	6,3
Air consumption max/free (l/sec)	32/16
Exhaust	Lateral
Noise (dB)	91
Vibration	<3,5 m/s <sup>2</sup>

Collet: standard delivery 6 mm. Optional dimension of collet available (please specify when ordering)



**STRAIGHT M-4**

Straight grinder with collet (CE)

Order number	GSB41 S10 CE	GSB41 S12 CE
Model	Banko M4 STRAIGHT	Banko M4 STRAIGHT
Max. free speed (rpm)	10000	12000
Collet diameter (mm)	6/8	6/8
Maximum Power (kW)	3.0	3.1
Weight (kg)	2.9	2.9
Length (mm)	435	435
Rec. hose dia. (mm)	19	19
Air inlet thread	1/2"	1/2"
Optimal pressure (bar)	6,3	6,3
Air consumption max/free (l/sec)	48/18	50/18
Exhaust	Lateral	Lateral
Noise (dB)	87	89
Vibration	<4,3 m/s <sup>2</sup>	<4,5 m/s <sup>2</sup>

Collet: standard delivery 6 mm. Optional dimension of collet available (please specify when ordering)



### STRAIGHT M-3

Straight grinder with collet (CE) EXTENDED VERSION

Order number	GSB31 2SS 18 CE	GSB31 3SS 18 CE	GSB31 4SS 18 CE	GSB31 5SS 18 CE
Model	Banko M3 Straight	Banko M3 Straight	Banko M3 Straight	Banko M3 Straight
Max. free speed (rpm)	18000	18000	18000	18000
Collet (mm)	6/8	6/8	6/8	6/8
Rec. / max. dia. carbide burr (mm)	16/16	16/16	16/16	16/16
Rec. / max. dia. mounted point (mm)	32/40	32/40	32/40	32/40
Maximum Power (kW)	2.0	2.0	2.0	2.0
Weight (kg)	3.3	3.75	4.2	4.65
Length (mm)	735	875	1015	1155
Rec. hose dia. (mm)	13	13	13	13
Air inlet thread	1/2"	1/2"	1/2"	1/2"
Optimal pressure (bar)	6,3	6,3	6,3	6,3
Air consumption max/free (l/sec)	32/16	32/16	32/16	32/16
Exhaust	Lateral	Lateral	Lateral	Lateral
Noise (dB)	91	91	91	91
Vibration	<3,5 m/s <sup>2</sup>	<3,5 m/s <sup>2</sup>	<3,5 m/s <sup>2</sup>	<3,5 m/s <sup>2</sup>

Collet: standard delivery 6 mm. Optional dimension of collet available (please specify when ordering)

#### Extension - info:

140 mm length per extension part  
with spindle thread  
3 ball bearings  
Connector for spindle  
Outside diameter: 28 mm

#### Available on request:

Other lengths



### STRAIGHT M-3

Straight grinder for grinding tools with thread (CW) EXTENDED VERSION

Order number	GSB31 2SS 18 CW	GSB31 3SS 18 CW	GSB31 4SS 18 CW	GSB31 5SS 18 CW
Model	Banko M3 STRAIGHT	Banko M3 STRAIGHT	Banko M3 STRAIGHT	Banko M3 STRAIGHT
Max. free speed (rpm)	18000	18000	18000	18000
Spindle thread	M12x1*	M12x1*	M12x1*	M12x1*
Rec. / max. dia. cone wheel (50 m/s)	40/50	40/50	40/50	40/50
Maximum Power (kW)	2.0	2.0	2.0	2.0
Weight (kg)	3.3	3.75	4.2	4.65
Length (mm)	735	875	1015	1155
Rec. hose dia. (mm)	13	13	13	13
Air inlet thread	1/2"	1/2"	1/2"	1/2"
Optimal pressure (bar)	6,3	6,3	6,3	6,3
Air consumption max/free (l/sec)	32/16	32/16	32/16	32/16
Exhaust	Lateral	Lateral	Lateral	Lateral
Noise (dB)	91	91	91	91
Vibration	<3,5 m/s <sup>2</sup>	<3,5 m/s <sup>2</sup>	<3,5 m/s <sup>2</sup>	<3,5 m/s <sup>2</sup>

\* INFO: 1 machine = 1 adapter free of charge (adapter size - page with adapter - please specify when ordering)

#### Extension - info:

140 mm length per extension part  
with spindle thread  
3 ball bearings  
Connector for spindle  
Outside diameter: 28 mm

#### Available on request:

Other lengths





## STRAIGHT M-4

Straight grinder with collet (CE) EXTENDED VERSION

Order number	GSB41 2SS 12 CE	GSB41 3SS 12 CE	GSB41 4SS 12 CE	GSB41 5SS 12 CE
Model	Banko M4 Straight	Banko M4 Straight	Banko M4 Straight	Banko M4 Straight
Max. free speed (rpm)	12000	12000	12000	12000
Collet (mm)	6/8	6/8	6/8	6/8
Rec. / max. dia. carbide burr (mm)	16/16	16/16	16/16	16/16
Rec./ max. dia. mounted point (mm)	32/40	32/40	32/40	32/40
Maximum Power (kW)	3.1	3.1	3.1	3.1
Weight (kg)	3.8	4.25	4.7	5.15
Length (mm)	730	870	1010	1150
Rec. hose dia. (mm)	19	19	19	19
Air inlet thread	1/2"	1/2"	1/2"	1/2"
Optimal pressure (bar)	6,3	6,3	6,3	6,3
Air consumption max/free (l/sec)	50/18	50/18	50/18	50/18
Exhaust	Lateral	Lateral	Lateral	Lateral
Noise (dB)	91	91	91	91
Vibration	<4,5 m/s <sup>2</sup>	<4,5 m/s <sup>2</sup>	<4,5 m/s <sup>2</sup>	<4,5 m/s <sup>2</sup>

Collet: standard delivery 6 mm. Optional dimension of collet available (please specify when ordering)

### Extension - info:

140 mm length per extension part  
with spindle thread  
3 ball bearings  
Connector for spindle  
Outside diameter: 28 mm

### Available on request:

Other lengths and grinder with 10,000 rpm



## STRAIGHT M-4

Straight grinder for grinding tools with thread (CW) EXTENDED VERSION

Order number	GSB41 2SS 12 CW	GSB41 3SS 12 CW	GSB41 4SS 12 CW	GSB41 5SS 12 CW
Model	Banko M4 Straight	Banko M4 Straight	Banko M4 Straight	Banko M4 Straight
Max. free speed (rpm)	12000	12000	12000	12000
Spindle thread	M12x1*	M12x1*	M12x1*	M12x1*
Rec. / max. dia. cone wheel (50 m/s)	63/80	63/80	63/80	63/80
Maximum Power (kW)	3.1	3.1	3.1	3.1
Weight (kg)	3.8	4.25	4.7	5.15
Length (mm)	730	870	1010	1150
Rec. hose dia. (mm)	19	19	19	19
Air inlet thread	1/2"	1/2"	1/2"	1/2"
Optimal pressure (bar)	6,3	6,3	6,3	6,3
Air consumption max/free (l/sec)	50/18	50/18	50/18	50/18
Exhaust	Lateral	Lateral	Lateral	Lateral
Noise (dB)	91	91	91	91
Vibration	<4,5 m/s <sup>2</sup>	<4,5 m/s <sup>2</sup>	<4,5 m/s <sup>2</sup>	<4,5 m/s <sup>2</sup>

\* INFO: 1 machine = 1 adapter free of charge (adapter size - page with adapter - please specify when ordering)

### Extension - info:

140 mm length per extension part  
with spindle thread  
3 ball bearings  
Connector for spindle  
Outside diameter: 28 mm

### Available on request:

Other lengths and grinder with 10,000 rpm

## VANE MACHINE OIL FREE

Oiled air can be used at any time, increases the service life of the machine

Patented technology



### DIE ANGLE M-2

Die angle grinder (DW)



### DIE ANGLE M-3

Die angle grinder (DW)

Order number	GAB21 D12 DW	GAB21 D85 DW	GAB31 D12 DW	GAB31 D85 DW
Model	Banko M2 DIE Angle	Banko M2 DIE Angle	Banko M3 DIE Angle	Banko M3 DIE Angle
Max. free speed (rpm)	12000	8500	12000	8500
Spindle thread	M14	M14	M14	M14
Rec. max. dia. grinding wheel	125	180	125	180
Maximum Power (kW)	2.2	2.2	1.8	1.8
Weight (kg)	1.9	1.9	2.6	2.6
Length (mm)	265	265	265	265
Rec. hose dia. (mm)	13	13	13	13
Air inlet thread	1/2"	1/2"	1/2"	1/2"
Optimal pressure (bar)	6,3	6,3	6,3	6,3
Air consumption max/free (l/sec)	32/16	32/16	32/16	32/16
Exhaust	Rear	Rear	Rear	Rear
Noise (dB)	90	90	90	90
Vibration	<3,2 m/s <sup>2</sup>	<3,2 m/s <sup>2</sup>	<3,2 m/s <sup>2</sup>	<3,2 m/s <sup>2</sup>



Recommendation for GAB21 DIE ANGLE models (article B2-16-04):  
1 m supply air hose with coupling and silencer

### DIE ANGLE M0

Die angle grinder

Order number	GDB01 A25 CES	GDB01 A18 CES
Model	Banko M0 DIE Angle	Banko M0 DIE Angle
Max. free speed (rpm)	25000	18000
Collet (mm)	6	6
Rec. / max. dia. carbide burr (mm)	12/16	12/16
Rec. / max. dia. mounted point (mm)	20/25	20/25
Maximum Power (kW)	0.75	0.75
Weight (kg)	0.99	0.99
Lenght (mm)	206.9	206.9
Rec. hose dia. (mm)	10	10
Air inlet thread	3/8"	3/8"
Druck - Optimal bar	6,3	6,3
Air consumption max/free (l/sec)	14/8	14/8
Exhaust	Rear	Rear
Noise (dB)	84	84
Vibration	<2,5 m/s <sup>2</sup>	<2,5 m/s <sup>2</sup>



Recommendation for GDB01 DIE and DIE EXTENDED models (article C1-16-01):  
1 m supply air hose with coupling and silencer



### DIE ANGLE M-2

Die angle grinder

with collet (CE)

for grinding tools with thread (CW)

Order number	GAB21 D12 CE	GAB21 D12 CW
Model	Banko M2 DIE Angle	Banko M2 DIE Angle
Max. free speed (rpm)	12000	12000
Collet (mm)	6 (8)	M12x1 *
Maximum Power (kW)	2.2	2.2
Weight (kg)	1.9	1.9
Lenght (mm)	265	265
Rec. hose dia. (mm)	13	13
Air inlet thread	1/2"	1/2"
Druck - Optimal bar	6,3	6,3
Air consumption max/free (l/sec)	32/16	32/16
Exhaust	Rear	Rear
Noise (dB)	90	90
Vibration	<3,2 m/s <sup>2</sup>	<3,2 m/s <sup>2</sup>



Recommendation for GAB21 DIE ANGLE models (article B2-16-04):  
1 m supply air hose with coupling and silencer

\* INFO: 1 machine = 1 adapter free of charge (adapter size - page with adapter - please specify when ordering)

Collet: standard delivery 6 mm. Optional dimension of collet available (please specify when ordering)

## VANE MACHINE OIL FREE

Oiled air can be used at any time, increases the service life of the machine

# BANKO

Patented technology



### ANGLE M-3

Angle grinder (DW)



### ANGLE M-4

Angle grinder (DW)

Order number	GAB31 A12 DW	GAB31 A85 DW	GAB41 A85 DW	GAB41 A66 DW
Model	Banko M3 ANGLE	Banko M3 ANGLE	Banko M4 ANGLE	Banko M4 ANGLE
Max. free speed (rpm)	12000	8500	8500	6600
Spindle thread	M14	M14	M14	M14
Rec. max. dia. grinding wheel	125	180	180	230
Maximum Power (kW)	1.8	1.8	2.8	2.8
Weight (kg)	2.6	2.6	3.4	3.4
Lenght (mm)	338	338	337	337
Rec. hose dia. (mm)	19	19	19	19
Air inlet thread	1/2"	1/2"	1/2"	1/2"
Optimal pressure (bar)	6,3	6,3	6,3	6,3
Air consumption max/free (l/sec)	32/16	32/16	50/18	50/18
Exhaust	Lateral	Lateral	Lateral	Lateral
Noise (dB)	91	91	92	92
Vibration	<4,9 m/s <sup>2</sup>	<4,7 m/s <sup>2</sup>	<4,8 m/s <sup>2</sup>	<4,8 m/s <sup>2</sup>

## Angle grinder for cup wheels (CW)

### ANGLE M-4

### TURBINE T-32

Order number	GAB41 A66 CW	GTB32 A66 CW
Model	Banko M4 ANGLE	Banko T32 ANGLE
Max. free speed (rpm)	6600	6600
Spindle thread	M14	M14
Rec. max. dia. grinding wheel	140/115x65	140/115x65
Maximum Power (kW)	2.8	5.0
Weight (kg)	3.4	3.5
Lenght (mm)	337	313
Rec. hose dia. (mm)	19	16
Air inlet thread	1/2"	1/2"
Optimal pressure (bar)	6,3	6,3
Air consumption max/free (l/sec)	50/18	62/19
Exhaust	Lateral	Lateral
Noise (dB)	92	87
Vibration	<4,8 m/s <sup>2</sup>	3,5 m/s <sup>2</sup>



### TURBINE T-2

Turbine Angle grinder (DW)

Order number	GTB21 D12 DW	GTB21 D85 DW
Model	Banko T21 ANGLE	Banko T21 ANGLE
Max. free speed (rpm)	12000	8500
Spindle thread	M14	M14
Rec. max. dia. grinding wheel	125	180
Maximum Power (kW)	3.5	3.5
Weight (kg)	2.2	2.5
Lenght (mm)	243	243
Rec. hose dia. (mm)	13	13
Air inlet thread	1/2"	1/2"
Optimal pressure (bar)	6,3	6,3
Air consumption max/free (l/sec)	45/14	45/14
Exhaust	Lateral	Lateral
Noise (dB)	78	79
Vibration	<3,0 m/s <sup>2</sup>	<3,0 m/s <sup>2</sup>



### TURBINE T-3

Turbine Angle grinder (DW)

Order number	GTB32 A85 DW	GTB32 A66 DW
Model	Banko T32 ANGLE	Banko T32 ANGLE
Max. free speed (rpm)	8500	6600
Spindle thread	M14	M14
Rec. max. dia. grinding wheel	180	230
Maximum Power (kW)	5.0	5.0
Weight (kg)	3.3	3.5
Lenght (mm)	313	313
Rec. hose dia. (mm)	16	16
Air inlet thread	1/2"	1/2"
Optimal pressure (bar)	6,3	6,3
Air consumption max/free (l/sec)	62/18	62/19
Exhaust	Lateral	Lateral
Noise (dB)	87	87
Vibration	3,5 m/s <sup>2</sup>	3,5 m/s <sup>2</sup>

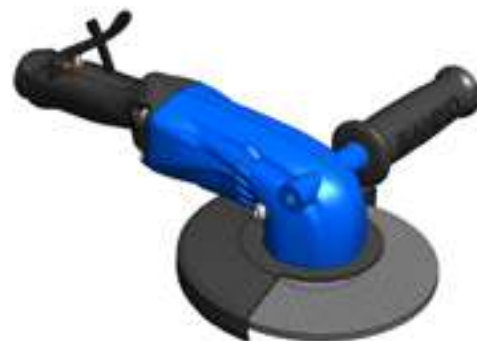

Disc set for cutting

Order number	Description
193-11-020	Disc washer for cutting
193-11-021	Disc nut for cutting

## VANE MACHINE OIL FREE

Oiled air can be used at any time, increases the service life of the machine

Patented technology



## VERTICAL M-5 POWER

Vertical grinder (DW)

Order number	GVB51P V85 DW	GVB51P V66 DW
Model	Banko M5P VERTICAL	Banko M5P VERTICAL
Max. free speed (rpm)	8500	6600
Spindle thread	5/8"	5/8"
Rec. max. dia. grinding wheel	180	230
Maximum Power (kW)	3.2	3.1
Weight (kg)	4.9	4.9
Length (mm)	210	210
Rec. hose dia. (mm)	19	19
Air inlet thread	1/2"	1/2"
Optimal pressure (bar)	6,3	6,3
Air consumption max/free (l/sec)	54/17	52/17
Exhaust	Lateral	Lateral
Noise (dB)	89	88
Vibration	<5,2 m/s <sup>2</sup>	<4,9 m/s <sup>2</sup>

Vertical grinder for cup wheels (CW)

GVB51P V66 CW
Banko M5P VERTICAL
6600
5/8"
140/115x65
3.1
4.9
210
19
1/2"
6,3
52/17
Lateral
88
<4,9 m/s <sup>2</sup>



**CONE WHEEL (CW) ADAPTER for DIE EXTENDED AND STRAIGHT GRINDER**

**1 a - Adapter**

Order number	Model / Description
194-06-017	Adapter for cone wheel M10
194-06-016	Adapter for cone wheel M12
194-06-015	Adapter for cone wheel M16
194-06-018	Adapter for cone wheel 5/8"

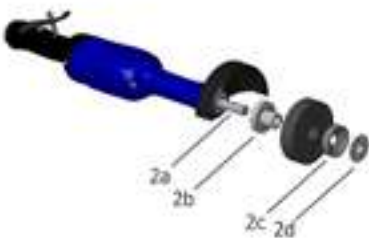

**STRAIGHT WHEEL (SW) ADAPTER for DIE EXTENDED AND STRAIGHT GRINDER**

**2 b - Adapter**

Order number	Model / Description
194-06-009	Spindle adapter STR 16 - 5/8"
194-06-020	Spindle adapter STR 20x20 - 5/8"
194-06-021	Spindle adapter STR 22x20 - 5/8"
194-06-022	Spindle adapter STR 25x20 - 5/8"
194-06-023	Spindle adapter STR 32x20 - 5/8"
194-06-004	Spindle adapter STR 20x32 - 5/8"
194-06-007	Spindle adapter STR 25x32 - 5/8"
	Hole x Width

Note: Additional "2 b" Straight Wheel (SW) adapters on request





**SPANNZANGE**

Order number	Description
101-13-001	Collet diametar 6 (mm)
101-13-003	Collet diametar 8 (mm)
101-13-004	Collet diametar 9 (mm)
101-13-005	Collet diametar 3 (mm)
101-13-006	Collet diametar 10 (mm)
101-13-007	Collet diametar 1/4"
101-13-008	Collet diametar 1/8"



**ADAPTER for CW (M12x1mm)**

Order number	Description
P0-01	Adapter from CW to CE (M12x1 to spindle / incl. 6 mm collet)
P0-02	Adapter from CW to CE (M12x1 to spindle / incl. 8 mm collet)
P0-03	Adapter from CW to CE (M12x1 to spindle / excl. collet)

# THE SMALL BEAST

**BANKO**  
INDUSTRIAL POWER TOOLS

The most powerful small hand-held grinder available in the market

**GTB21**  
3,5 kW / 2,2 kg



Unmatched power-to-weight ratio provide extreme material removal rate with minimum effort which allows new levels of productivity

## Benefits

- ▶ The most efficient grinding with half the weight for an extreme material removal rate with minimum effort
- ▶ Much less insensitivity to variation of pressure, impossible to stall with the right hose and pressure
- ▶ Grinding with much less vibration due to grinding of the wheel at the constant right speed
- ▶ Oil-less grinding which enables clean surface and more environmentally friendly operation
- ▶ Ergonomically shaped and balanced design for less operator fatigue and easy control

## Features

- ▶ The most efficient 6 stage turbine motor
- ▶ Precise stainless steel governor working under any pressure and condition
- ▶ Adjustable wheel guard

Order number	GTB21 D12 DW	GTB21 D85 DW
Model	Banko T21 Angle	Banko T21 Angle
Max. free speed (rpm)	12000	8500
Spindle thread	M14	M14
Rec. / max. dia. grinding wheel (mm)	125	180
Maximum Power (kW)	3,5	3,5
Weight (kg)	2,2	2,5
Lenght (mm)	243	243
Rec. hose dia. (mm)	13	13
Air inlet thread	1/2"	1/2"
Optimal pressure (bar)	6,3	6,3
Air consumption max/free (l/sec)	45/14	45/14
Exhaust	Lateral	Lateral
Noise (dB)	78	79
Vibration (m/s <sup>2</sup> )	<3,0	<3,0

# THE BEAST

**BANKO**  
INDUSTRIAL POWER TOOLS

The most powerful hand-held grinder available in the market

## GTB32

5,0 kW / 3,3 kg



Unmatched power-to-weight ratio provide extreme material removal rate with minimum effort which allows new levels of productivity



### Benefits

- ▶ The most efficient grinding with half the weight for an extreme material removal rate with minimum effort
- ▶ Much less insensitivity to variation of pressure, impossible to stall with the right hose and pressure
- ▶ Grinding with much less vibration due to grinding of the wheel at the constant right speed
- ▶ Oil-less grinding which enables clean surface and more environmentally friendly operation
- ▶ Ergonomically shaped and balanced design for less operator fatigue and easy control

### Features

- ▶ The most efficient 6 stage turbine motor
- ▶ Precise stainless steel governor working under any pressure and condition
- ▶ Adjustable wheel guard

Order number	GTB32 A85 DW	GTB32 A66 DW
Model	Banko T32 Angle	Banko T32 Angle
Max. free speed (rpm)	8500	6600
Spindle thread	M14	M14
Rec. / max. dia. grinding wheel (mm)	180	230
Maximum Power (kW)	5.0	5.0
Weight (kg)	3.3	3.5
Lenght (mm)	313	313
Rec. hose dia. (mm)	16	16
Air inlet thread	1/2"	1/2"
Optimal pressure (bar)	6,3	6,3
Air consumption max/free (l/sec)	62/18	62/19
Exhaust	Lateral	Lateral
Noise (dB)	87	87
Vibration (m/s <sup>2</sup> )	3,5	3,5



## STUCCHI ALBERI FLESSIBILI S.R.L

Via Monte Bisbino, 42  
20021 Baranzate (MI)

Tel. +39 02 3562550

Fax. +39 02 33301084

[stucchi@stucchi-flessibili.com](mailto:stucchi@stucchi-flessibili.com)

[www.stucchi-flessibili.com](http://www.stucchi-flessibili.com)

# BANKO

## INDUSTRIAL POWER TOOLS

### **BANKO INDUSTRIAL POWER TOOLS**

Address:  
Dubrovačka 19  
21000 Split  
Croatia

Production:  
Hrvatskih velikana b.b.  
21251 Žrnovnica  
Croatia

Contact:  
Tel.: + 385 21 540 010  
Fax: + 385 21 540 022  
[info@banko.hr](mailto:info@banko.hr)  
[www.banko.hr](http://www.banko.hr)